

PRODUCT NUMBER
SEE P/N SCHEME

NOTES:

- MATERIAL:
HSG: OPTIONS, UL94V-0, OPTIONAL COLORS.
TERMINAL: HIGH CONDUCTIVITY COPPER ALLOY.
PLATING: OPTIONAL ON CONTACT AREA.
- THIS HEADER MATES WITH FCI RECEPTACLE WIRE CONNECTOR 10127815, CRIMPING 10130517 FOR HIGH CURRENT APPLICATION.
- PRODUCT SPECIFICATION: GS-12-1333.
- PACKAGE SPECIFICATION: GS-14-2362.
- THE HOUSING WILL WITHSTAND EXPOSURE TO 235°C PEAK TEMPERATURE FOR 5 SECONDS IN A WAVE SOLDER APPLICATION WITH A 1.6mm MINIMUM THICK CIRCUIT BOARD. (FOR PA66)
THE HOUSING WILL WITHSTAND EXPOSURE TO 260°C PEAK TEMPERATURE FOR 10 SECONDS IN A REFLOW OVEN. (FOR LCP ONLY)
- PART NUMBER SCHEME:
10131318-XX X X X X X LF

POS. CODE:
02: 2 POS.
5
24: 24 POS.
S1: SEE SHEET 2
S2: SEE SHEET 2

LOCATING PEG:
O: NONE (TRAY)
P: BOTH PEGS (TRAY)
R: NONE (TAPE/REEL)

GLOW WIRE COMPATIBLE:
O: NO, PA66 CM3004
G: YES, PA66 C3U OR LCP E130i

CONTACT PLATING:
1: GOLD FLASH
2: 80u" BRIGHT TIN
4: 30u" GOLD
5: 100u" MATTE TIN

HSG MATERIAL:
1: NYLON 66
2: LCP E130i (-XXXX2GXLF)

HSG COLOR:
1: NATURAL
2: BLACK

7. DIMENSIONAL & PART NO. TABLE:

PART NUMBER	POS.	A	B
10131318-02XXXXXL	02	4.2	5.4
10131318-04XXXXXL	04	4.2	9.6
10131318-06XXXXXL	06	8.4	13.8
10131318-08XXXXXL	08	12.6	18.0
10131318-10XXXXXL	10	16.8	22.2
10131318-12XXXXXL	12	21.0	26.4
10131318-14XXXXXL	14	25.2	30.6
10131318-16XXXXXL	16	29.4	34.8
10131318-18XXXXXL	18	33.6	39.0
10131318-20XXXXXL	20	37.8	43.2
10131318-22XXXXXL	22	42.0	47.4
10131318-24XXXXXL	24	46.2	51.6

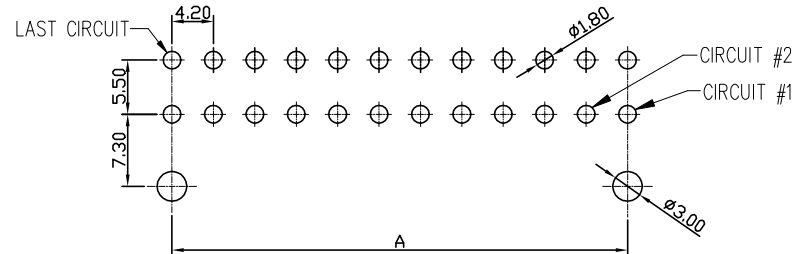
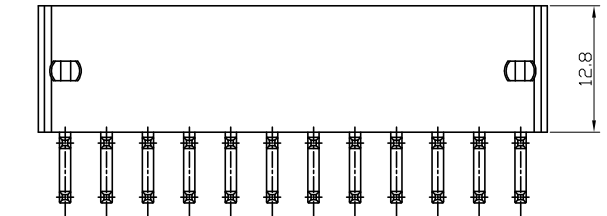
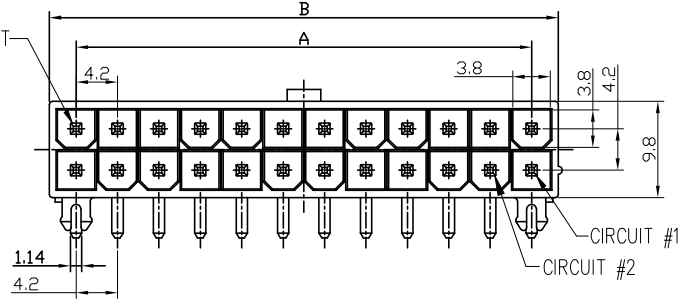
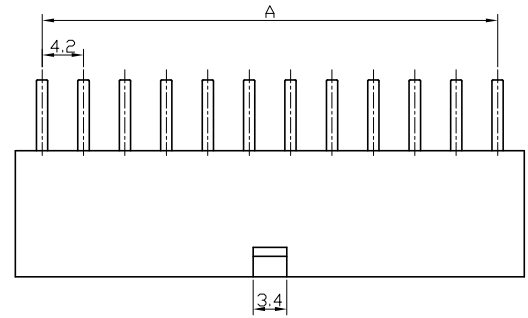
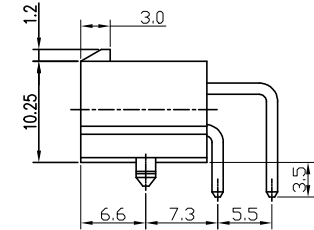

PCB LAYOUT COMPONENT SIDE

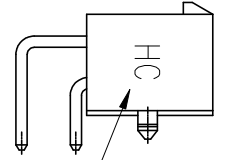

MARK OF "HIGH CURRENT"

mat'l. code		surface	tolerance	projection	product family	
ltr		ecn no	dr	date	MINITEK PWR4.2 HCC	
tolerances unless otherwise specified					title	
A	TAI	2014-08-29	angles	X.X±0.4	MINITEK PWR4.2 HIGH CURRENT HEADER DUAL ROW, R/A, DIP TYPE	
B	ELX-T-19532	TAI	2014-11-24	X.XX±0.30		
C	ELX-T-21754	TAI	2015-08-24	X*±1*	scale	
D	ELX-T-24683	TAI	2016-08-09	dr	KENNY TAI	2014-08-12
E	ELX-T-27707	TONY	2017-08-15	engr	KENNY TAI	2014-08-12
F	ELX-N-29299	TONY	2018-02-06	chr	KENNY TAI	2014-08-12
G	ELX-N-32661	TONY	2019-02-13	appd	PM ZHENG	2014-08-29
sheet	revision	G	G			
index	sheet	1	2			

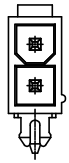

2 POS

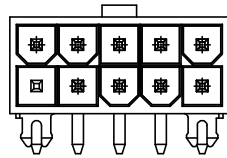

10 POS

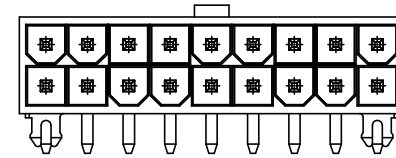

18 POS

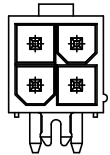

4 POS

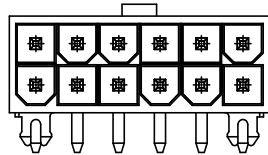

12 POS

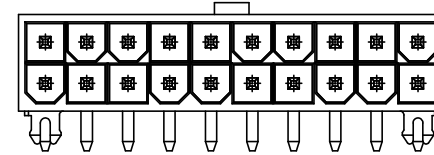

20 POS

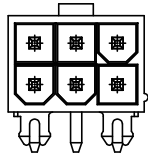

6 POS

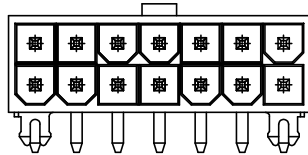

14 POS

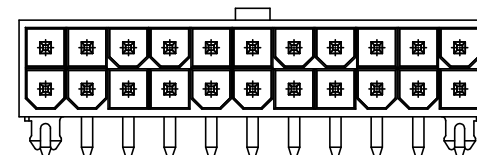

22 POS

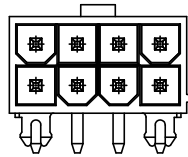

8 POS

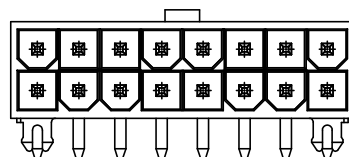

16 POS

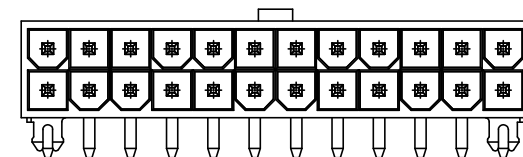

24 POS

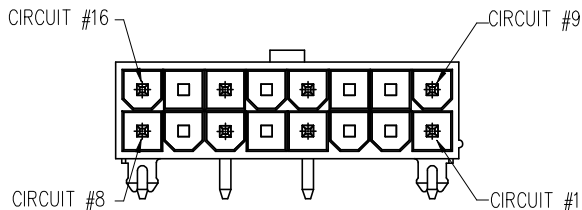

S1: CIRCUIT 2,3,5,7,10,11,13,15 REMOVED

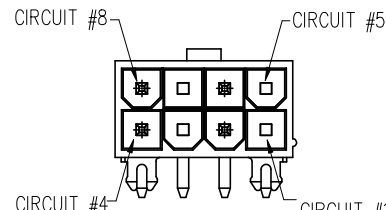

S2: CIRCUIT 1,3,5,7 REMOVED

mat'l. code		surface	tolerance	projection	product family							
			<input checked="" type="checkbox"/>		MINITEK PWR4.2 HCC							
ltr	ecn no	dr	date	tolerances unless otherwise specified		title						
				<table border="1"> <tr> <td>angles</td> <td>linear</td> <td>X.X±0.4</td> </tr> <tr> <td></td> <td></td> <td>X.XX±0.30</td> </tr> </table>		angles	linear	X.X±0.4			X.XX±0.30	MINITEK PWR4.2 HIGH CURRENT HEADER DUAL ROW, R/A, DIP TYPE
angles	linear	X.X±0.4										
		X.XX±0.30										
				mm	dwg no							
				scale	sheet 2 of 2 size							
					10131318							
					type Product Customer Drawing							
sheet index	revision sheet	G	G									
		1	2									