

SOLDER TAIL TYPE DRAWING

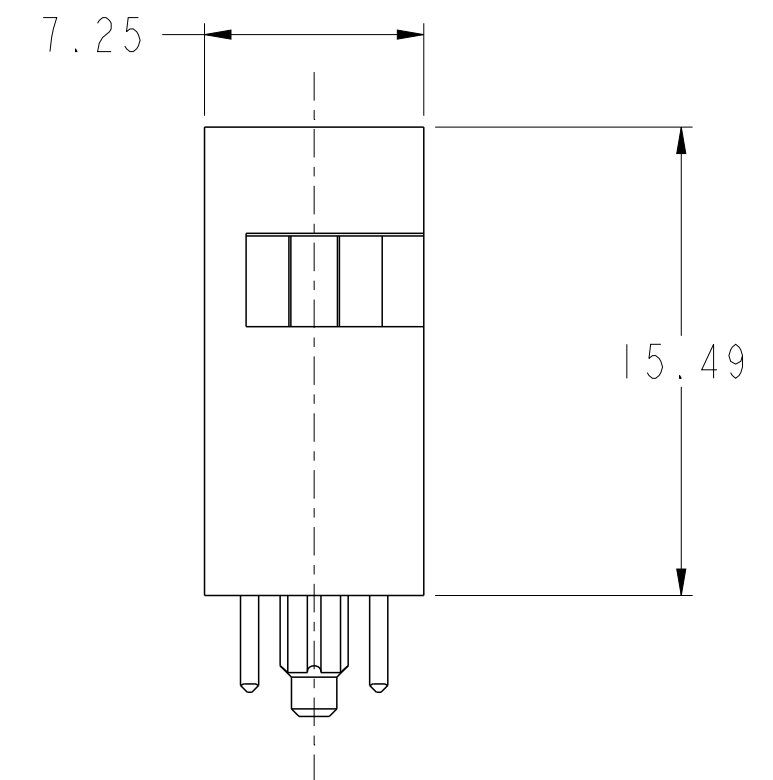
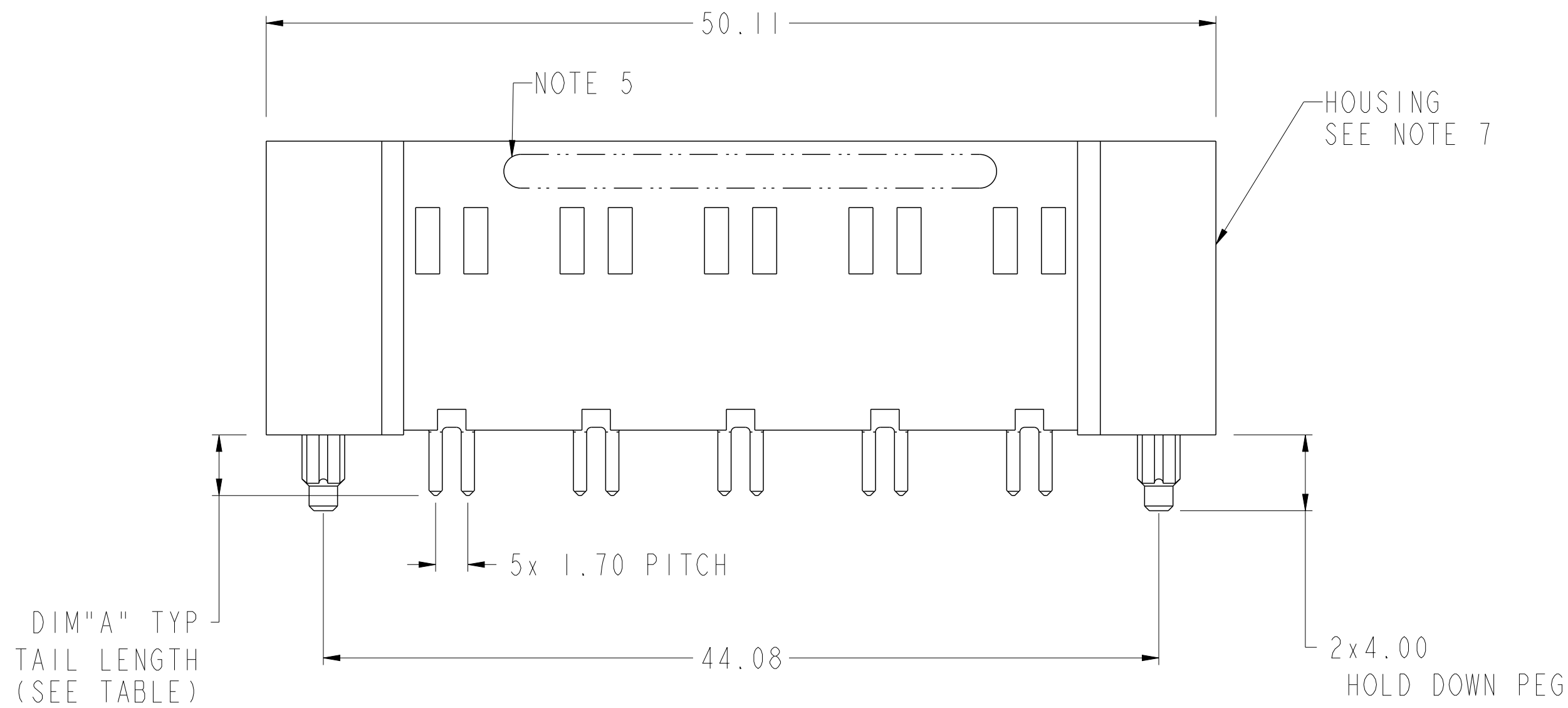
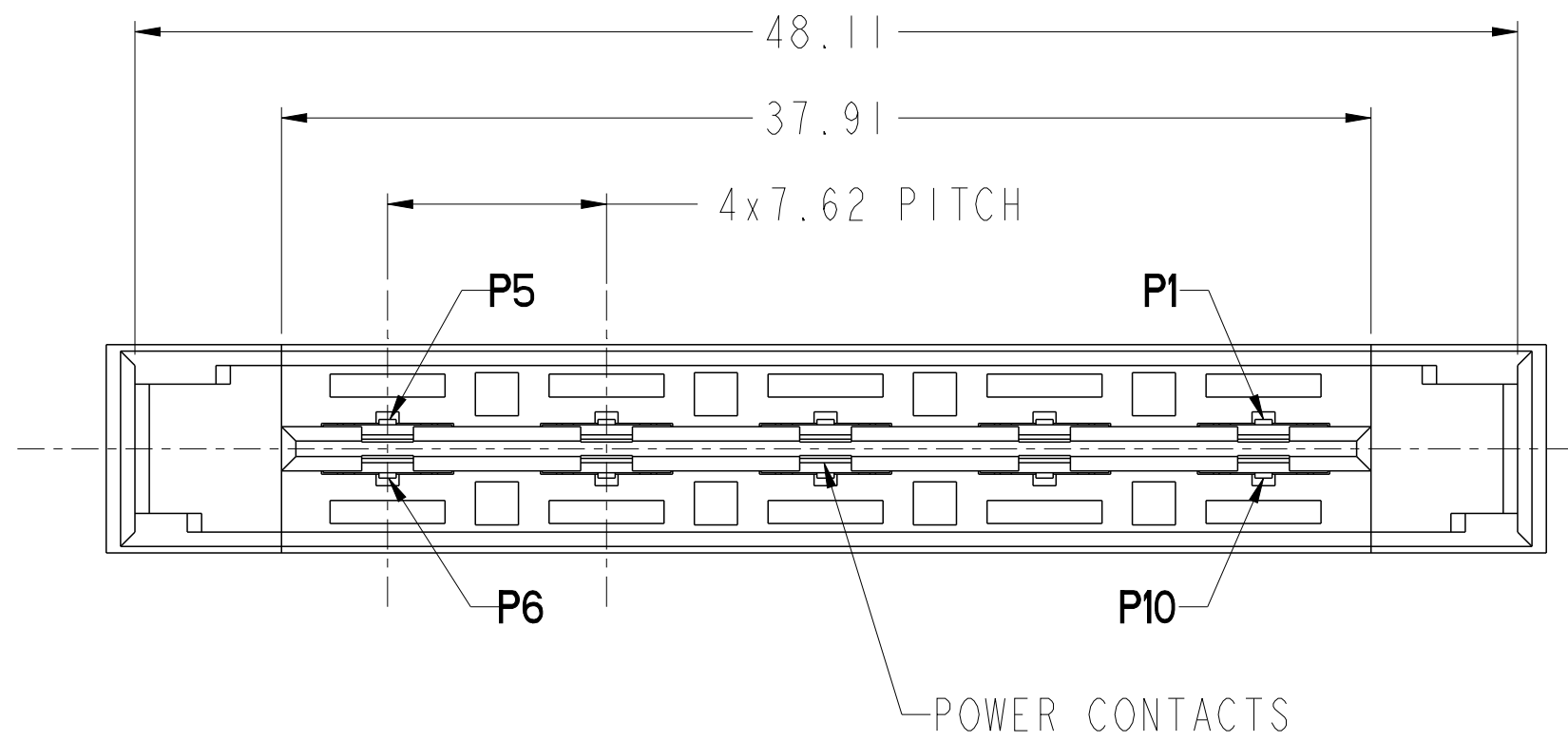

spec ref	-	dr	Hai-Ling Liu	2015/01/16	projection	MM	size	A2	scale	4:1		
tolerance std	ASME Y14.5 ISO 1101	eng	Hai-Ling Liu	2016/03/01			ecn no	ELX-DG-23383-1				
TOLERANCES UNLESS OTHERWISE SPECIFIED		chr	Terris Liu	2016/03/01			rel level	Released				
surface	linear	0.X	±0.5	0.XX			±0.25	0.XXX	±0.10	product family	-	rel level
ASME Y14.5	angular	0°	±2°	Amphenol FCi	title	HPCE CTB VERTICAL HEADER		10HP	cat. no.	-	Product - Customer Drw	sheet 1 of 4
								dwg no	10133099		rev	B

PRESS FIT TAIL TYPE DRAWING

A

B

C

D

E

F

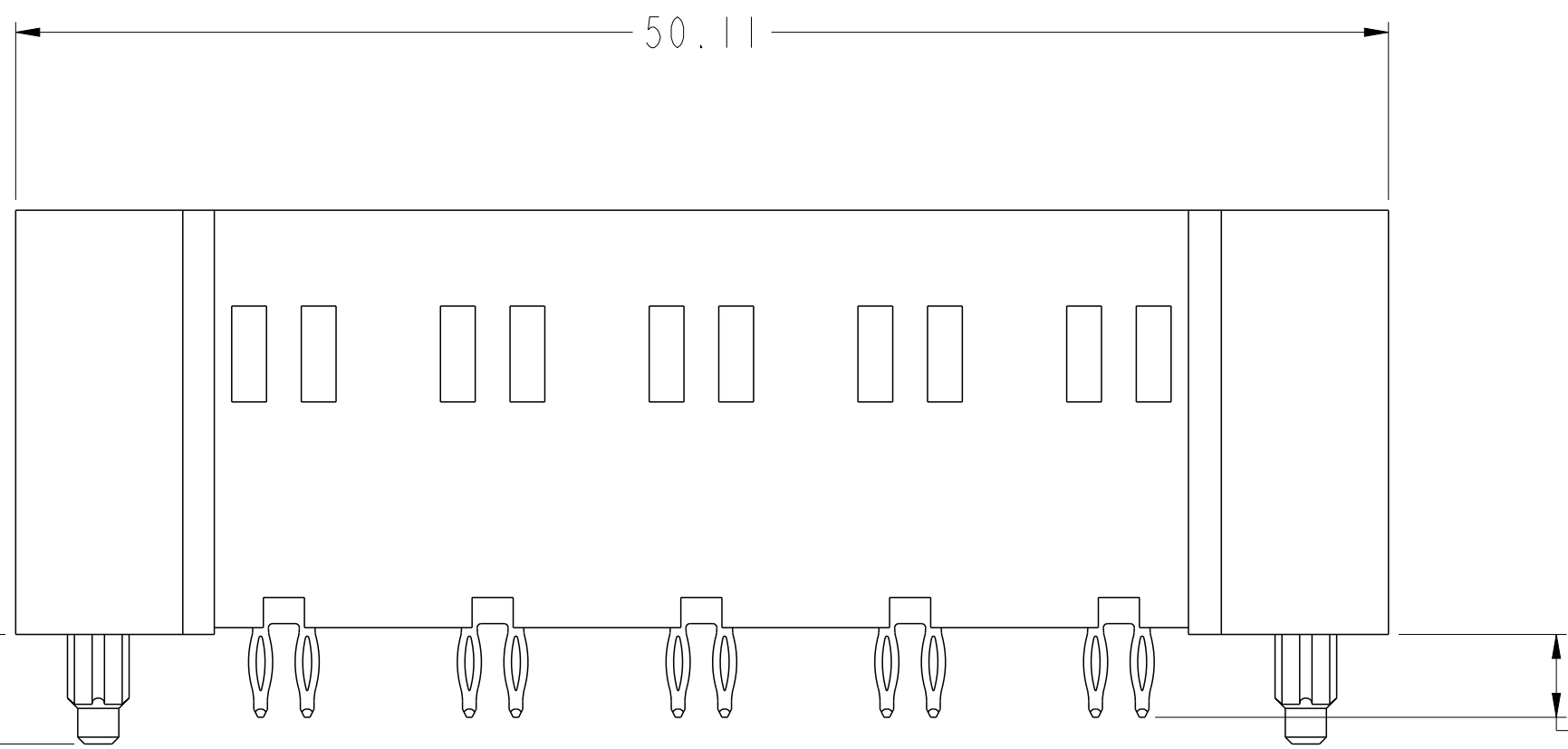
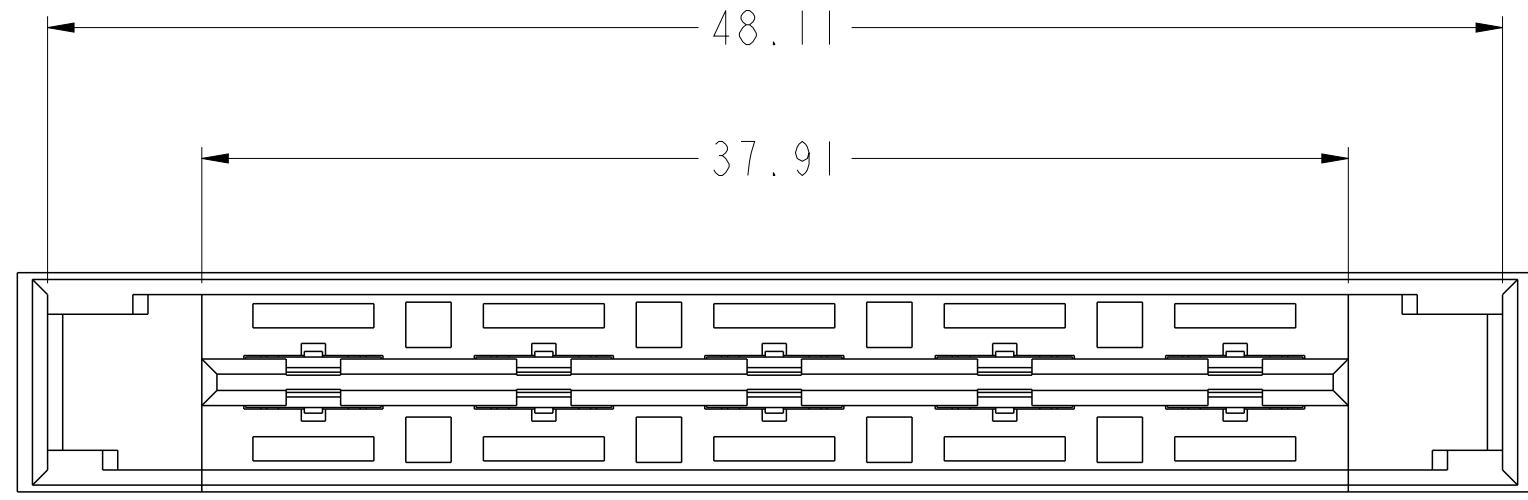

DIM A TYP
TAIL LENGTH
SEE TABLE

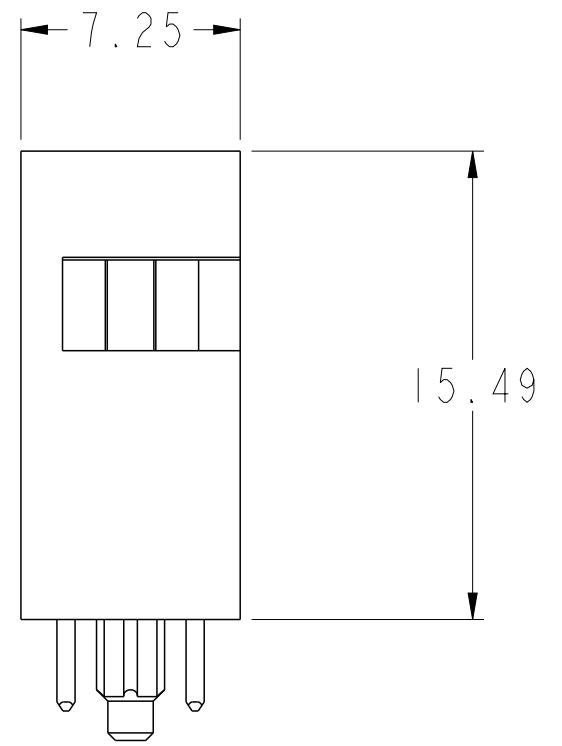

OROTHER DIMMENSIONS ARE SAME AS PAGE 1(SOLDER TAIL TYPE)

Amphenol
FCi

© 2016 AFci

spec ref	-	dr	Hai-Ling Liu	2015/01/16	projection	MM	size	A2	scale	4:1		
tolerance std	ASME Y14.5 ISO 1101	eng	Hai-Ling Liu	2016/03/01			ecn no	ELX-DG-23383-1				
TOLERANCES UNLESS OTHERWISE SPECIFIED		chr	Terris Liu	2016/03/01				rel level	Released			
surface	linear	0.X	±0.5	appr	Pai-Ming Zheng	2016/03/01	product family					
		0.XX	±0.25	Amphenol FCi		title	HPCE CTB VERTICAL HEADER		dwg no	10133099	rev	B
		0.XXX	±0.10			10HP						
ASME Y14.5	angular	0°	±2°			cat. no.			Product - Customer Drw		sheet 2 of 4	

PDS: Rev :B

STATUS:Released

Printed: Mar 01, 2016

CONTACT TYPE	TOP LAYER DESCRIPTION	TABLE 1 (HPCE / SOLDER TAILS) PLATED THROUGH-HOLE REQUIREMENTS				
		DRILLED HOLE DIAMETER	COPPER THICKNESS	TIN-LEAD THICKNESS	TIN THICKNESS	FINISHED HOLE DIAMETER
POWER & SIGNAL	TIN-LEAD	1.10-1.16 (1.15 DRILL)	0.025 - 0.050	0.005 - 0.015	--	0.94 - 1.10
	IMMERSION TIN	1.10-1.16 (1.15 DRILL)	0.025 - 0.050	--	0.9 - 1.5um	0.94 - 1.10
	COPPER (SEE NOTE 8)	1.10-1.16 (1.15 DRILL)	0.025 - 0.050	--	--	0.94 - 1.10
CONTACT TYPE	TOP LAYER DESCRIPTION	TABLE 1 (HPCE / PRESS FIT TAILS) PLATED THROUGH-HOLE REQUIREMENTS				
		DRILLED HOLE DIAMETER	COPPER THICKNESS	TIN-LEAD THICKNESS	TIN THICKNESS	FINISHED HOLE DIAMETER
POWER	TIN-LEAD	8.10-8.60 (0.85 DRILL)	0.025 - 0.050	0.005 - 0.015	--	0.65 - 0.80
	IMMERSION TIN	8.10-8.60 (0.85 DRILL)	0.025 - 0.050	--	0.9 - 1.5um	0.70 - 0.80
	COPPER (SEE NOTE 8)	8.10-8.60 (0.85 DRILL)	0.025 - 0.050	--	--	0.70 - 0.80

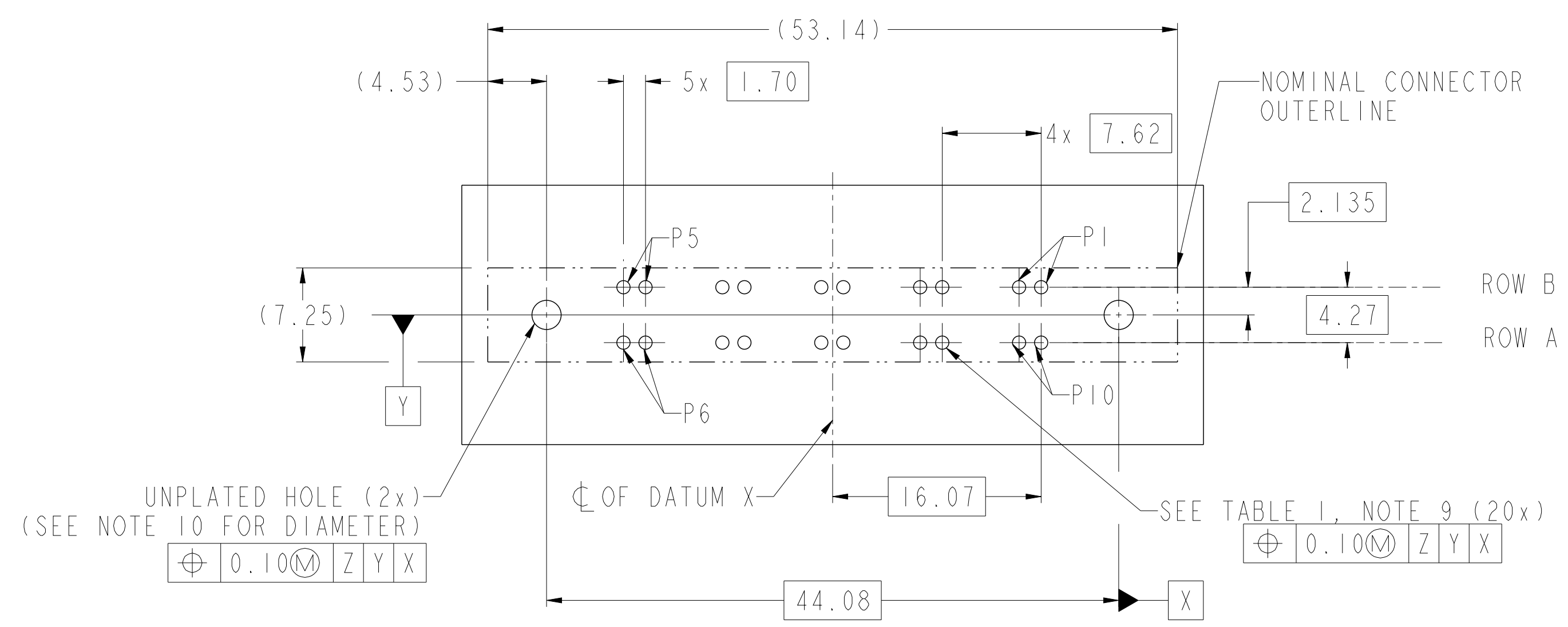

RECOMMENDED PCB LAYOUT
VIEW FROM CONNECTOR SIDE

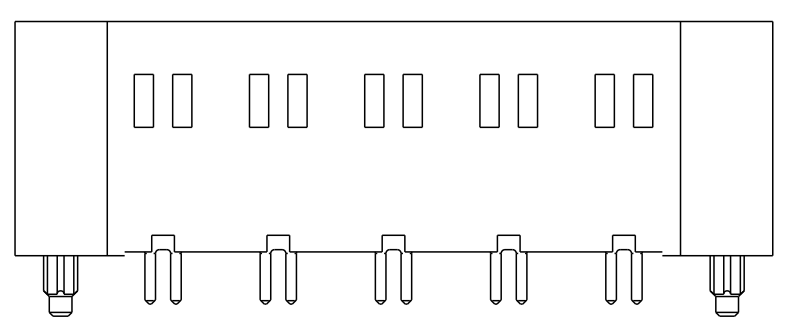

SCALE 2:1

spec ref	-	dr	Hai-Ling Liu	2015/01/16	projection	MM	size	A2	scale	4:1
tolerance std	ASME Y14.5 ISO 1101	eng	Hai-Ling Liu	2016/03/01			ecn no	ELX-DG-23383-1		
TOLERANCES UNLESS OTHERWISE SPECIFIED		chr	Terris Liu	2016/03/01				rel level	Released	
surface	linear	appr	Pei-Ming Zheng	2016/03/01	product family	-	rel level	Released		
ASME Y14.5	angular	0°	±2°	0.X ±0.5	Amphenol FCI		title	HPCE CTB VERTICAL HEADER		rev
		0.XX ±0.25	0.XXX ±0.10	10HP	cat. no.	-	Product - Customer Drw	sheet 3 of 4		B

PRODUCT PART NUMBER

10133099-□□□□□LF

BASE PART NUMBER

CONTACT AREA PLATING
 UNDERPLATED 50u"(1.27um) MIN. NICKEL
 1: 30u"(0.760um) MIN. GXT

FIRST MATE LAST BREAK PIN POSITION
 000: ALL PINS ARE LONG PINS SEE TABLE

DIM "A", TAIL LENGTH

- 1: 2.60±0.25mm (STB TAIL,PCB THK 1.57±0.13mm)
- 2: 3.25±0.25mm (STB TAIL ,PCB THK 2.36±0.13mm)
- 3: 3.04±0.25mm (PF TAIL ,PCB THK 1.57MM MIN)

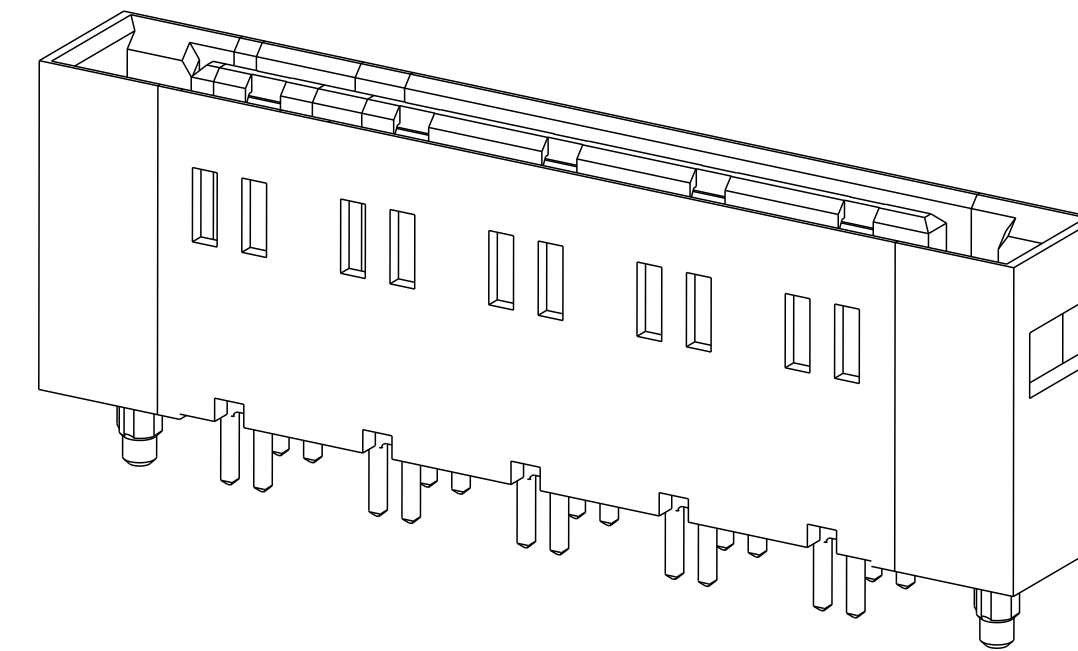

NOTES:

1. CONNECTOR MATERIALS:

HOUSING: HIGH TEMPERATURE THERMAL PLASTIC, BLACK UL 94V-0 COMPLIANT

CONTACTS: HIGH PERFORMANCE COPPER ALLOY.

2. CONTACT FINISH REF. GS-12-1031 SECTION 5.2

3. PRODUCT SPECIFICATION: GS-12-1031

4. APPLICATION SPECIFICATION: GS-20-0369

⑤ PRODUCT MARKING (FCI PART NUMBER & DATE CODE) ON HOUSING IN AREA SHOWN.

6. PACKAGING MEETS FCI SPECIFICATION GS-14-2272

⑦ HOUSING COMPONENT WILL WITHSTAND EXPOSURE TO 260°C PEAK TEMPERATURE FOR 60 SECONDS IN A CONVECTION, INFRA-RED, OR VAPOR PHASE REFLOW OVEN.

⑧ COPPER PLATING THICKNESS IN CENTER OF VIA-HOLE CAN BE NO MORE THAN 0.003 LESS THAN OTHER AREAS.

⑨ ALL HOLE SIZES ARE FINISHED HOLE SIZES.

⑩ MOUNTING HOLES ARE UNPLATED
 ∅ 2.25±0.05 FOR SOLDER TAILS
 ∅ 2.40±0.10 FOR PF TAILS

spec ref	-	dr	Hai-Ling Liu	2015/01/16	projection	MM	size	A2	scale	4:1	
tolerance std	ASME Y14.5 ISO 1101	eng	Hai-Ling Liu	2016/03/01			ecn no	ELX-DG-23383-1			
TOLERANCES UNLESS OTHERWISE SPECIFIED		chr	Terris Liu	2016/03/01			rel level	Released			
surface	linear	appr	Pai-Ming Zheng	2016/03/01	product family	-	dwg no	10133099			
ASME Y14.5	angular	0°	±2°	0.X ±0.5 0.XX ±0.25 0.XXX ±0.10	Amphenol FCi	title	HPCE CTB VERTICAL HEADER			rev	B
				cat. no.	-	Product - Customer Drw	sheet 4 of 4				