

This document is the property of Amphenol Corporation and is delivered on the express condition that it is not to be disclosed, reproduced or used, in whole or in part, for manufacture or sale by anyone other than Amphenol Corporation without its prior consent, & that no right is granted to disclose or to use any information in this document.

CUSTOMER DRAWING

REVISIONS

SYM	ECN	DESCRIPTION	DATE	APPROVED
1	CDXXXX	PROPOSAL DRAWING	Jul.17,2018	
2	CDXXXX	UPDATED NOTES	Jul.20,2018	
3	CDXXXX	FOLLOW SFF TA 1002 V1.1.2	Aug.20,2018	
4	CDXXXX	UPDATED BY SFF TA 1002 V1.1.3	Nov.05,2018	

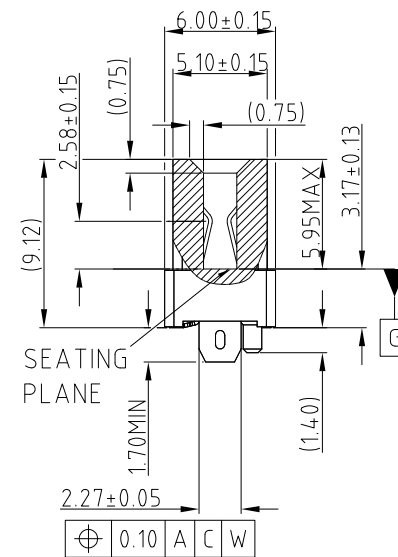
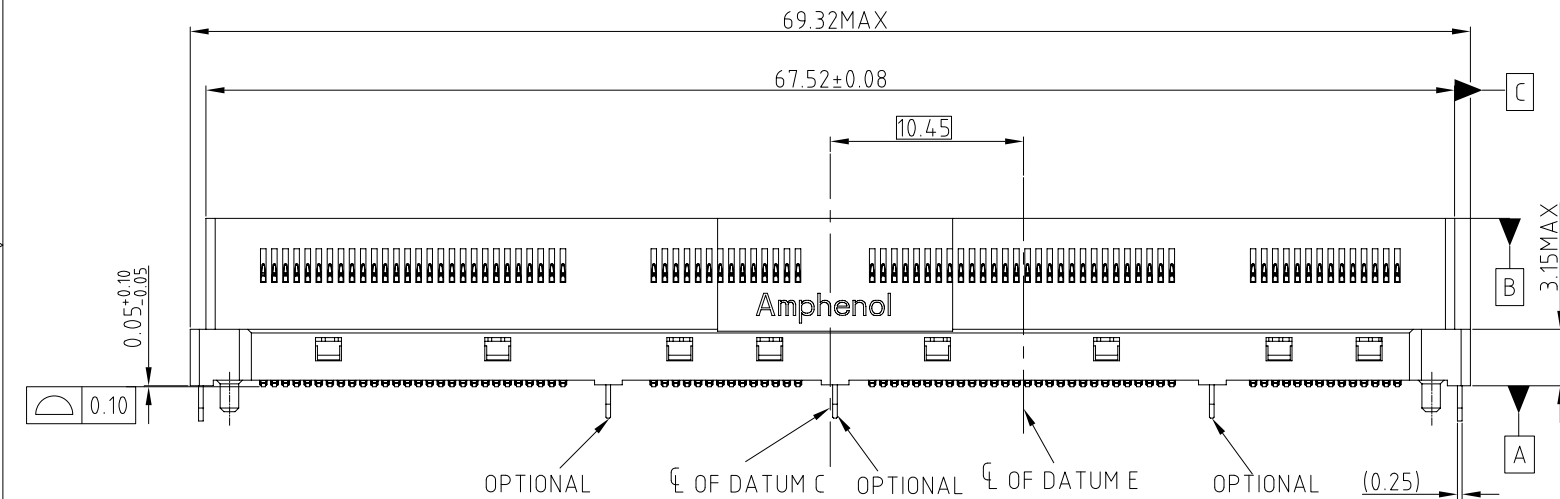
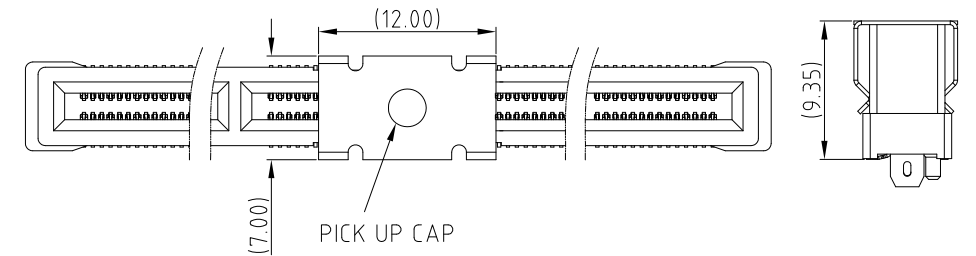
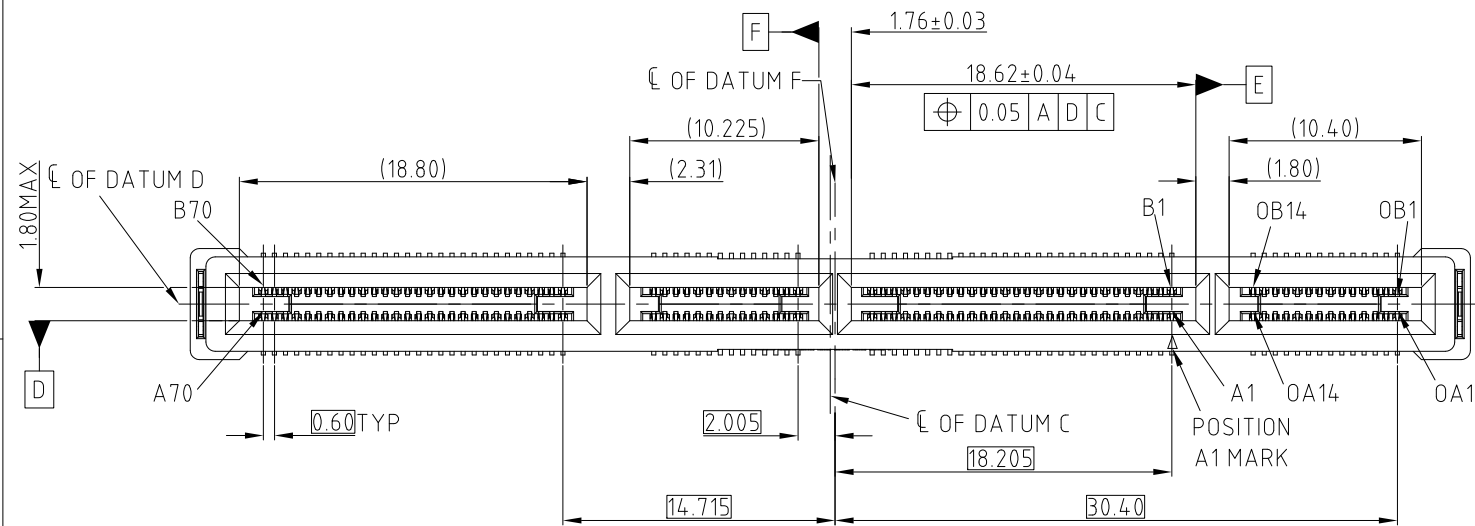

NOTE:

- MATERIAL:
HOUSING: HIGH TEMPERATURE THERMOPLASTIC BLACK UL94-V0
CONTACT: COPPER ALLOY
BOARDLOCK: COPPER ALLOY
- PLATING:
CONTACT: MATING AREA: SEE PLATING SEPC OVER 1.27-2.54 μ NICKEL UNDERPLATED
SOLDER AREA: 1.27 MIN TIN OVER 1.27-2.54 μ NICKEL UNDERPLATED
BOARDLOCK: 1.27 MIN TIN OVER 1.27-2.54 μ NICKEL UNDERPLATED
- ELECTRICAL PERFORMANCE:
RATED CURRENT : 1.1A/PIN UP TO 12PINS
LLCR:30mΩ MAX, DELTA 15 mΩ.
INSULATION RESISTANCE: 1000MΩ MIN
- DURABILITY:200 CYCLES.
- MATERIAL SHOULD BE FULFILLED AMPHEONL SPEC# S-SN-002 AND S-SN-004
- ORDERING PN SYSTEM: ME101681010101X

- PLATING SPEC
- 0.76um Au
 - 0.38um Au
 - GOLD FLASH
 - PdNi 0.76um+GF

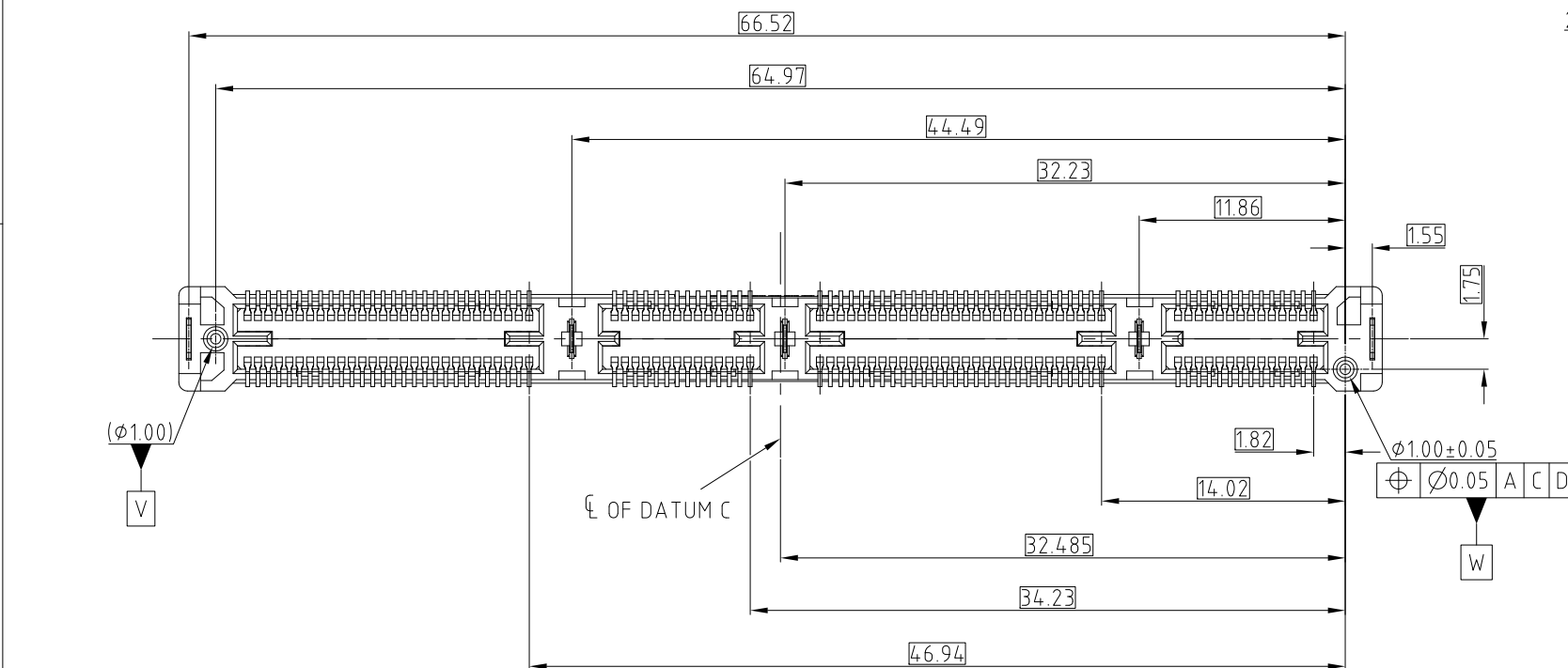

PROPOSAL DRAWING

UNLESS OTHERWISE SPECIFIED TOLERANCES		APPROVAL		DATE	Amphenol
U.S. METRIC		DRAWN	Rocky	Nov.05,2018	
.X	+/-	0.25			
.XX	+/-	0.20	Ly.YI	Nov.05,2018	
.XXX	+/-	0.15			
FRACTIONS +/-		APPROVED			
ANGLES +/-		DRAWING FILE :			
5°		INTERNAL\ME\C ME101681010101X			
FOR MATERIALS AND FINISHES SEE NOTES		REMOVE SHARP EDGES		ANGLE OF PROJECTION	
DIMENSIONS		—U.S.—		INCHES	
(METRIC)		(mm)		SCALE	
				NONE	
				SHEET 1 OF 2	
				REV. 4	
				TITLE	
				MINI COOL EDGE CONNECTOR	
				168PIN V/T 0.6MM PITCH SMT	
				SIZE	
				DRAWING NO.	
				A3 C ME101681010101X	
				REV. 4	

This document is the property of Amphenol Corporation and is delivered on the express condition that it is not to be disclosed, reproduced or used, in whole or in part, for manufacture or sale by anyone other than Amphenol Corporation without its prior consent, & that no right is granted to disclose or to use any information in this document.

CUSTOMER DRAWING

REVISIONS				
SYM	ECN	DESCRIPTION	DATE	APPROVED
		SEE SHEET 1		

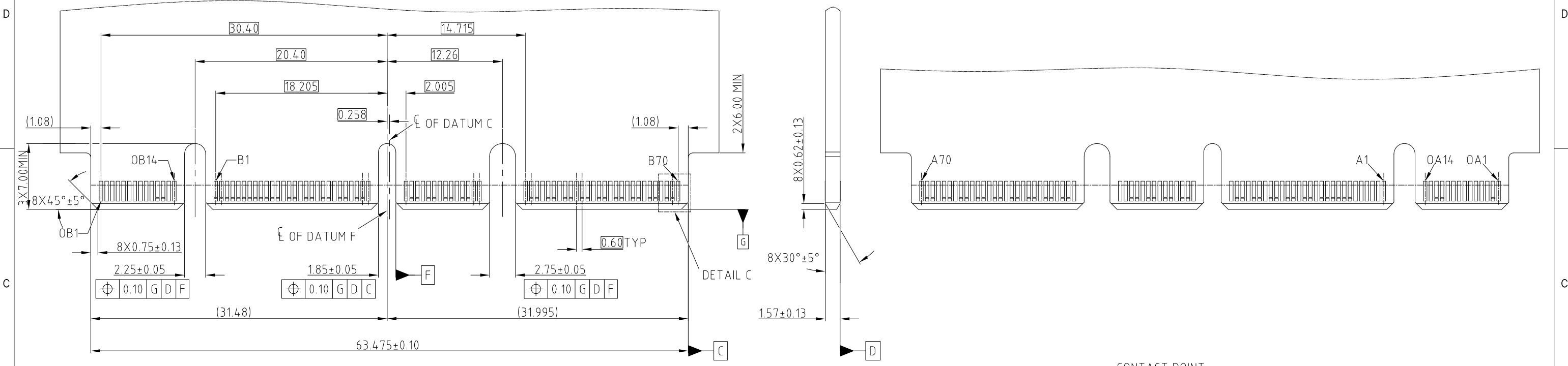

RECOMMENDED AIC MATING CARD

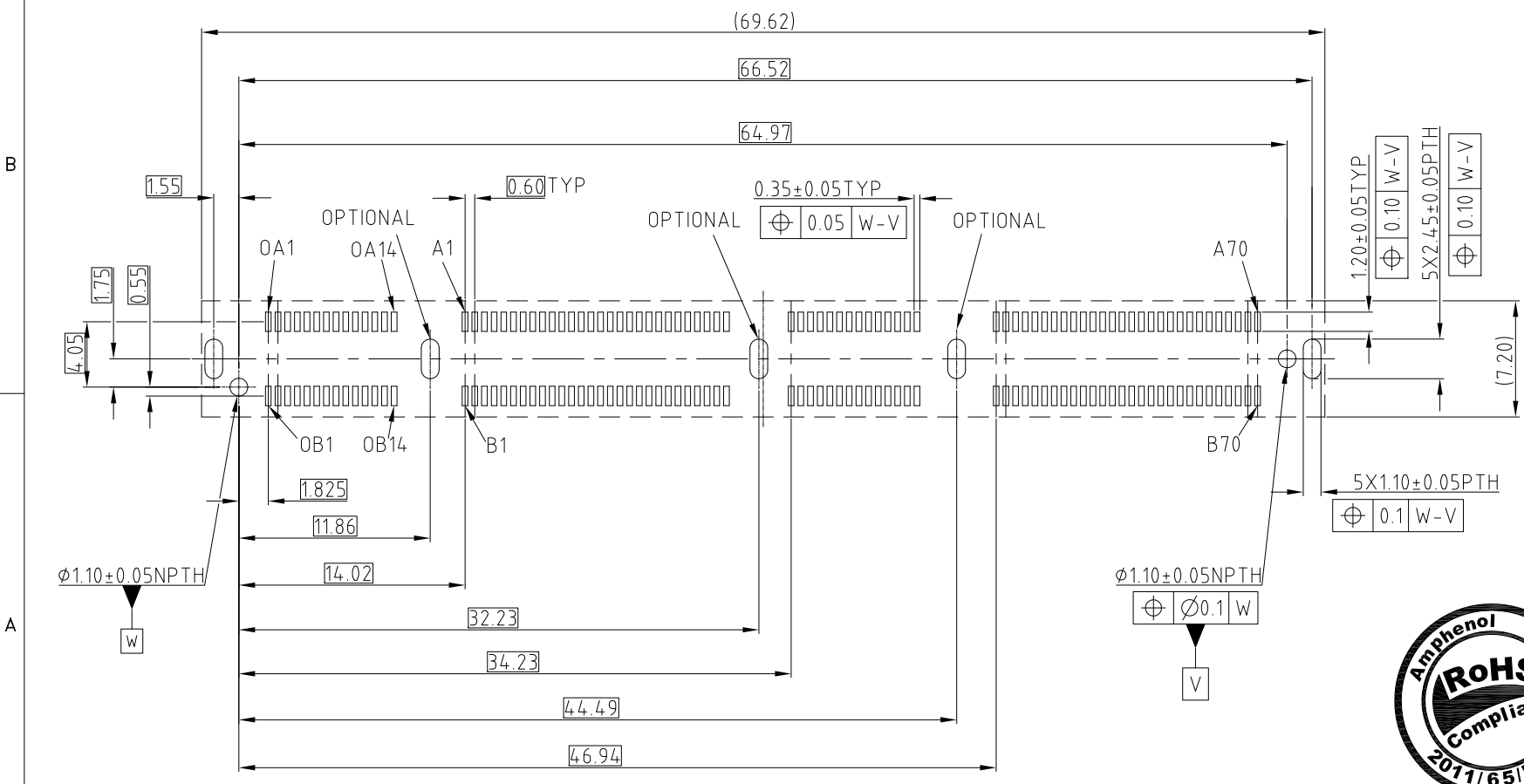

RECOMMENDED FOOTPRINT

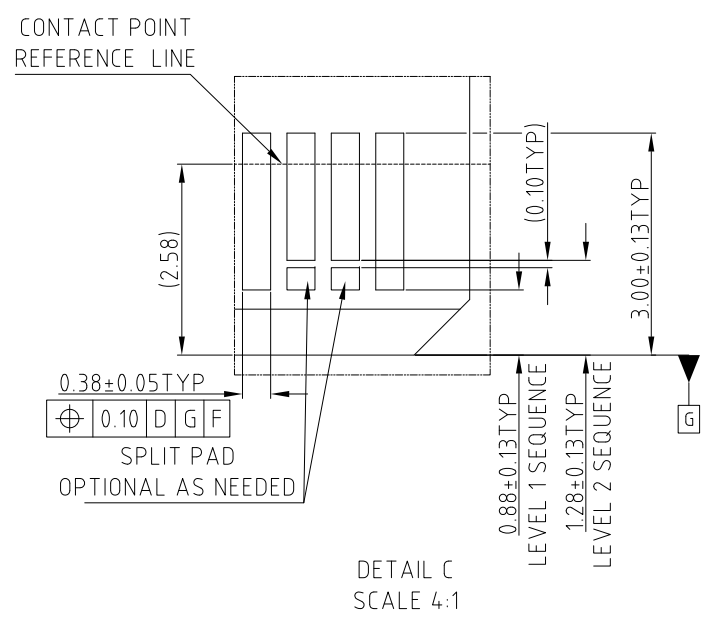

PROPOSAL DRAWING

UNLESS OTHERWISE SPECIFIED TOLERANCES		APPROVAL		DATE	Amphenol
	U.S. METRIC	DRAWN	Rocky	Nov.05,2018	
.X	+/- 0.25	CHECKED	Ly.Yi	Nov.05,2018	
.XX	+/- 0.20	APPROVED			
.XXX	+/- 0.15	DRAWING FILE :		INTERNAL\ME\C ME101681010101X	
FRACTIONS	+/- 5°	REMOVE SHARP EDGES		ANGLE OF PROJECTION	
ANGLES	+/-	DIMENSIONS			
FOR MATERIALS AND FINISHES SEE NOTES		—U.S.—		INCHES	
		(METRIC)		(mm)	
		TITLE		MINI COOL EDGE CONNECTOR	
		SIZE		DRAWING NO.	
		A3		C ME101681010101X	
		SCALE		NONE	
		SHEET		2 OF 2	
		REV.		4	